

## 181 Series - Crimp All SS Welded Liquid Filled Pressure Gauge

181 Series is all SS gauge with crimp bezel, glycerine/Silicon filled and argon-arc welding.



181A



181B

### Description

This series is designed for critical environment or high pure devices, it has SS304 housing and SS316 internals, can be used in most corrosive atmospheres, vibration, pulsation environments, etc.

### Material Feature

<b>Case</b>	SS304	<b>Connection</b>	SS316 NPT/BSP/BSPT/Metric
<b>Ring</b>	SS304	<b>Thread Size</b>	1/8", 1/4", M14
<b>Window</b>	Polycarbonate or Tempered Glass	<b>Movement</b>	SS304
<b>Dial</b>	Aluminium	<b>Bourdon Tube</b>	SS316L
<b>Pointer</b>	Aluminium	<b>Welding Type</b>	Argon-arc Welding
<b>Accuracy</b>	1.6%/1.0%*	<b>Pres. Range</b>	VAC~9PSI~15000PSI

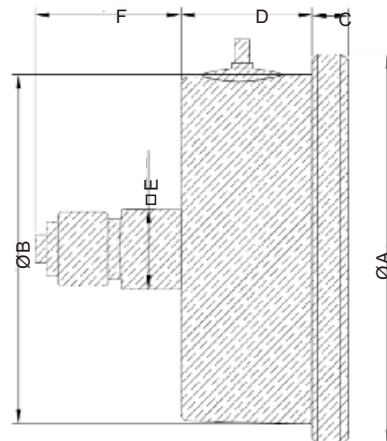
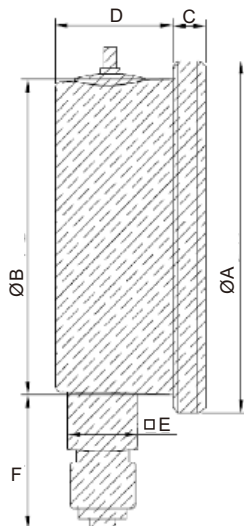

### DIMENSIONS

Code	Dia (mm)	Size (mm)					
		A	B	C	D	E	F
B181	50	57.5	50.5	6.5	22.0	14.0	26.0
C181	63	68.0	61.0	6.5	22.0	14.0	26.0